

How to use.

Setup, Cleaning and Packdown

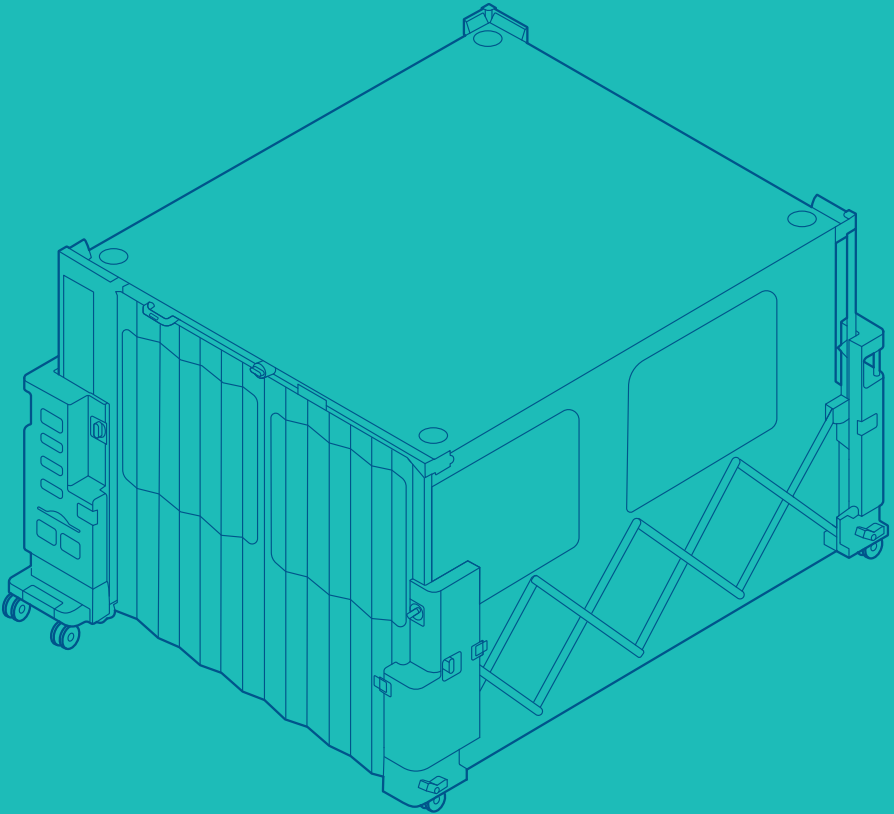

PRODUCT CONTENTS

One Rediroom Personal Protective Equipment Cart

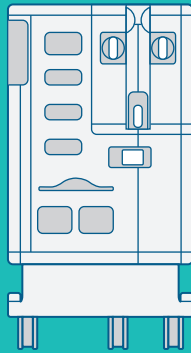

Front

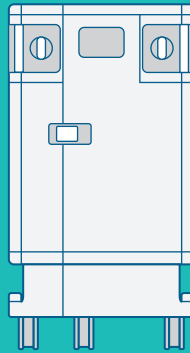

Back

A REDIROOM CANOPY

A small or large
Rediroom canopy
(ordered separately)



TRAVEL LOCKING PIN

To prevent damage to your Rediroom, the travel locking pin must be removed before the Rediroom is deployed and replaced if the Rediroom is shipped from site to site.

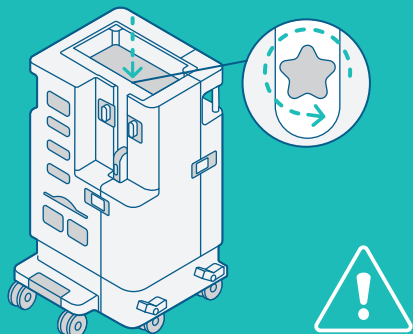

Scan the QR code to watch our demonstration video.

REDIROOM SETUP

Rediroom can be setup in **5 minutes**.

The **numbered** decals help guide you through setup.

The **letter** decals will help you when you come to pack Rediroom away, but you can ignore those for now.

LOADING THE CANOPY

Load the canopy into the top of the Rediroom cart. Hang the handle of the bag from the hook, tear along the perforations and attach the coloured connectors (decals 1).

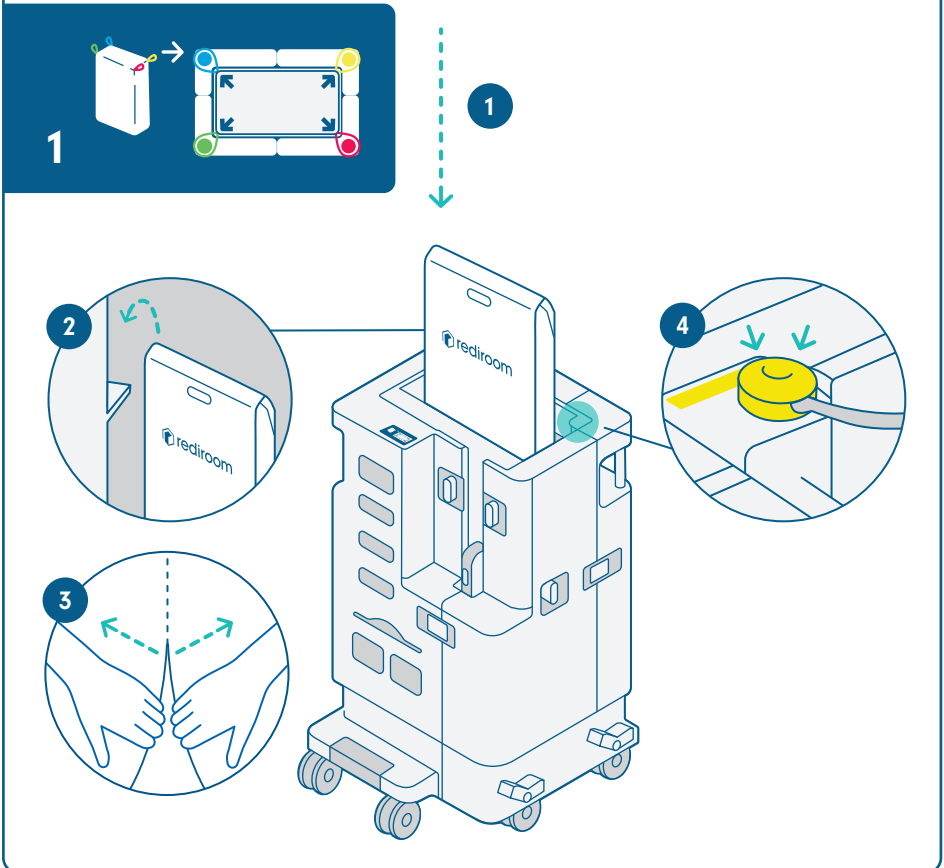

GETTING INTO POSITION

Lock the rear, left wheel. Leave the others unlocked. (Decal 2).

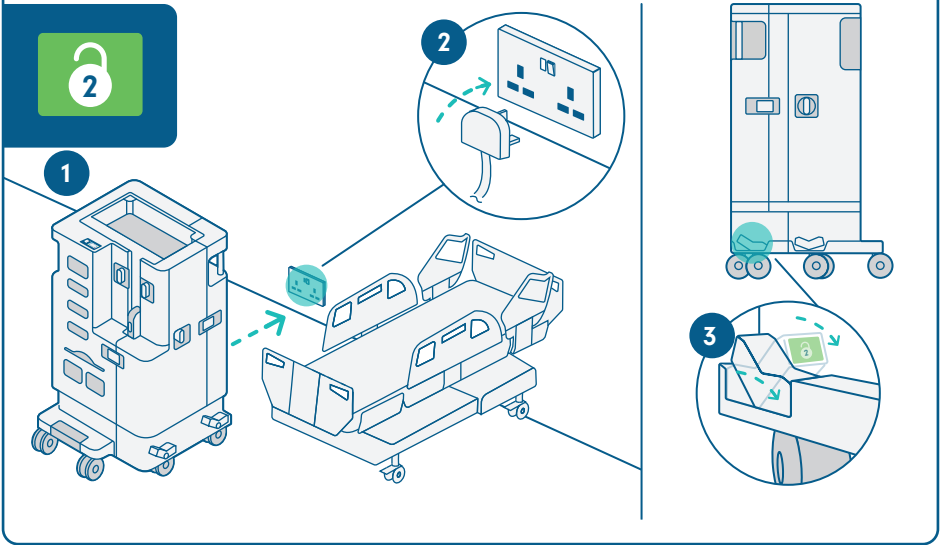

RAISING THE FRAME

Follow decals 3, 4 and 5.

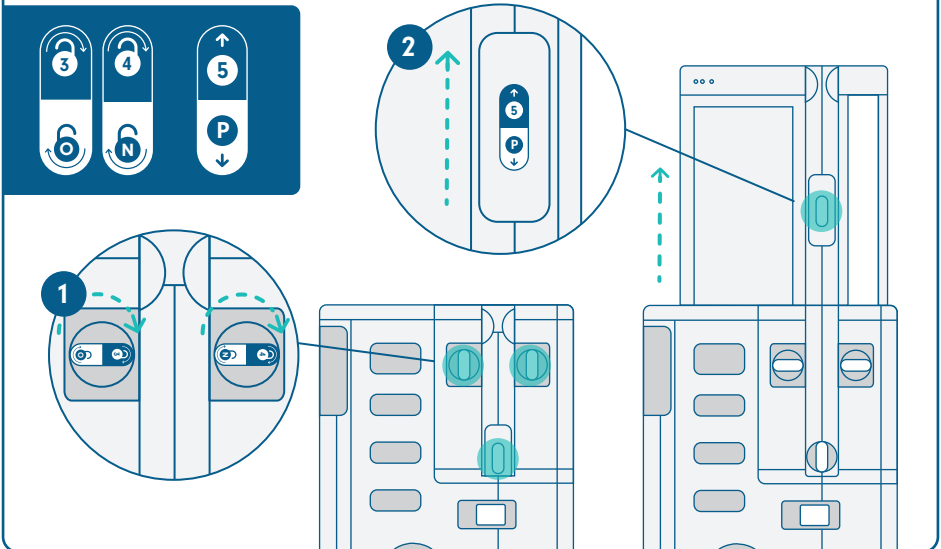

EXPANDING OUTWARDS

Unlock **decals 6 and 7**. Expand the Rediroom out to the right slightly. Unlock **decal 8** and then fully extend. Once in place, lock the rear, right wheel (**decal 9**). Only the rear wheels should be locked now.

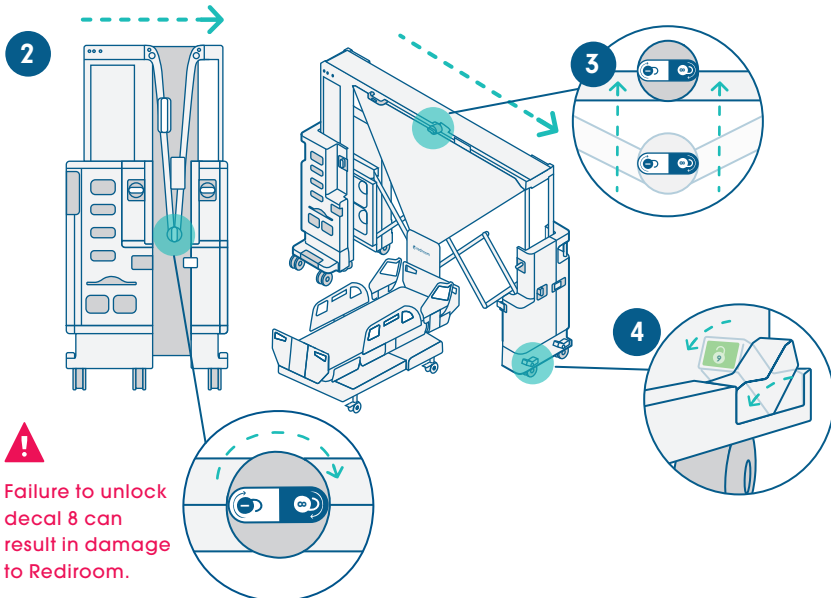
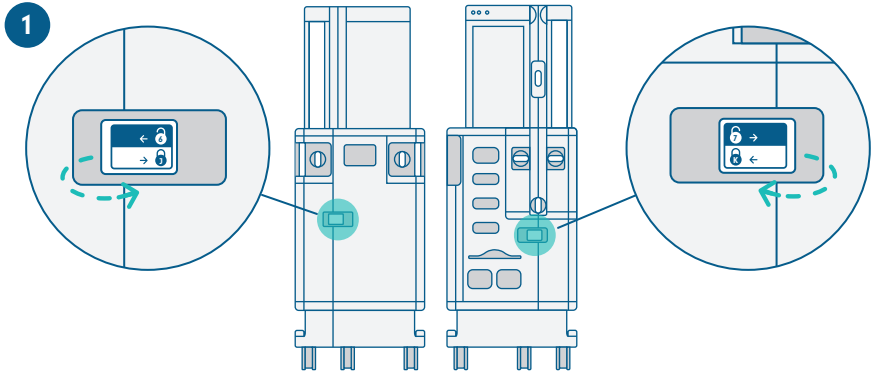

THE FULL FRAME

Unlock **decals 6 and 7**. Expand the Rediroom out to the right slightly. Unlock **decal 8** and then fully extend. Once in place, lock the rear, right wheel (**decal 9**). Only the rear wheels should be locked now.

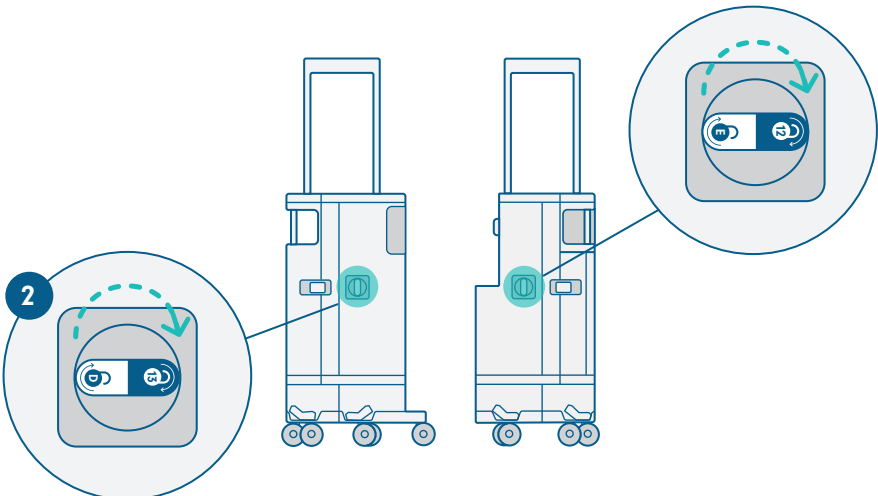
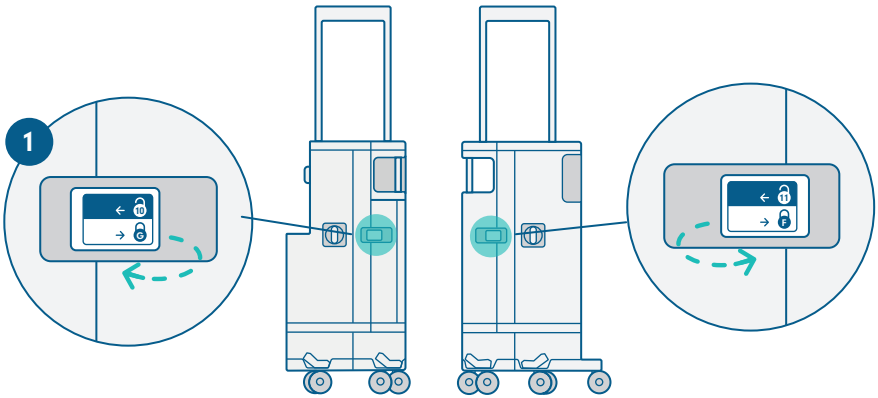

12

13

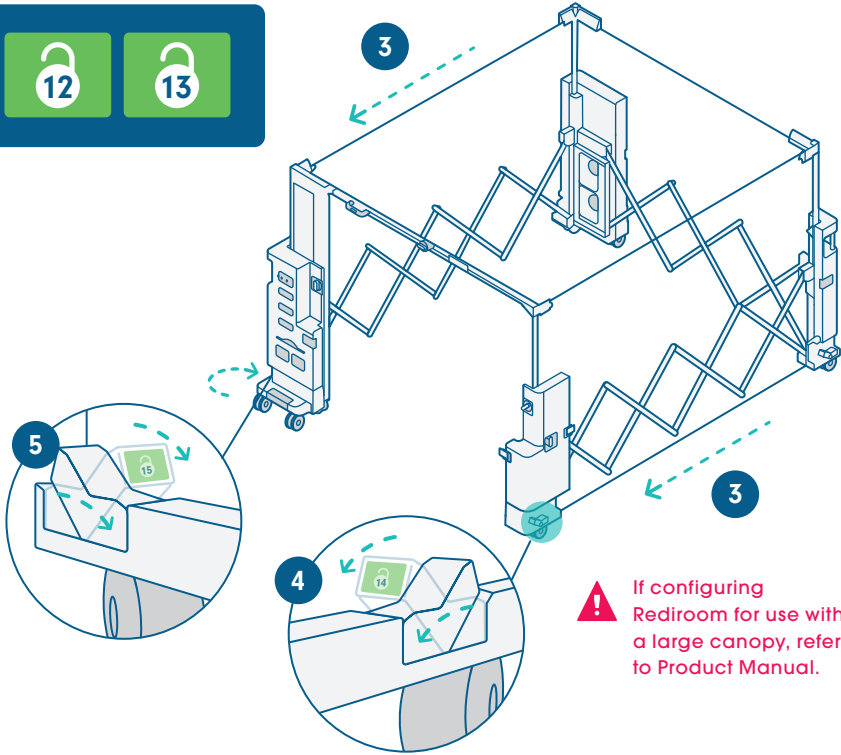

HANGING THE CANOPY

Attach the doors to the front curtain rail, start from the middle (metal hooks) and work outwards.

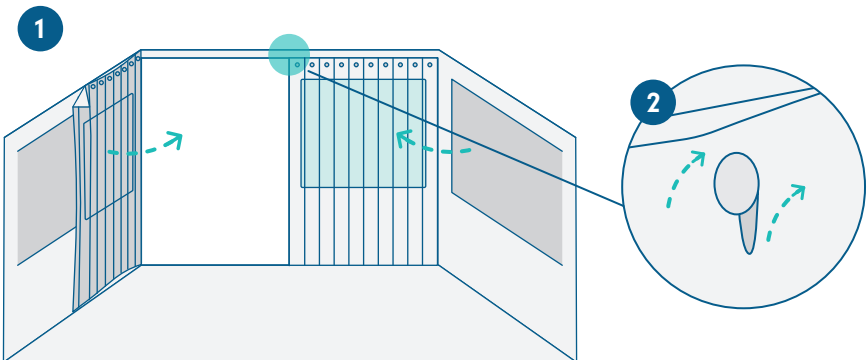

INSIDE THE CANOPY

Attach the HEPA filter to the fan filter unit and remove the yellow sticker. When the HEPA filter is attached correctly you'll hear the fans power up.

Stick the canopy to the floor starting in the rear corners. Once all four corners are in place, stick down the back and side walls.

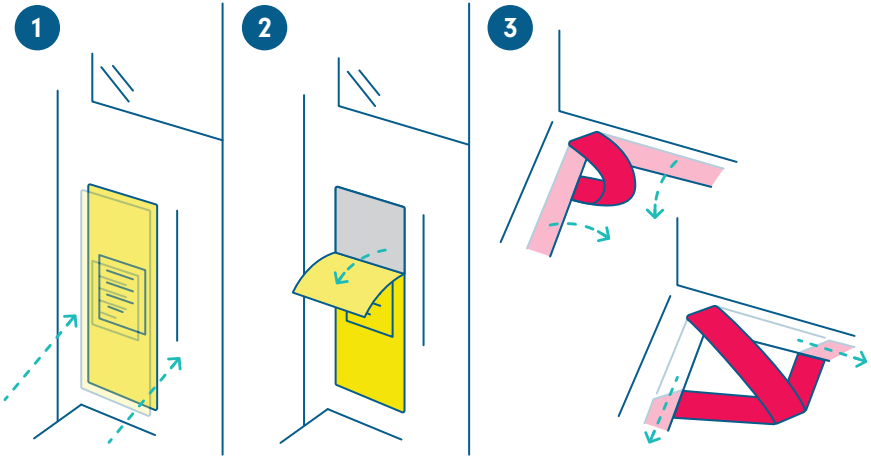

SET UP AND READY TO USE

Rediroom is now set up and ready to use.

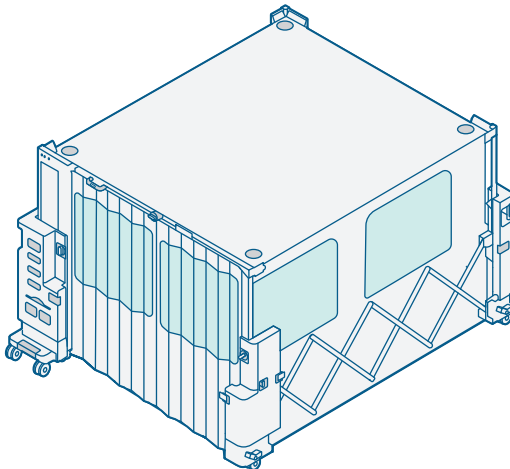

WHEN IN USE

FOOT PEDALS

There are three foot pedals to open and close the doors. Two located inside Rediroom, left and right of the exit door, one located on the PPE cart outside of Rediroom.

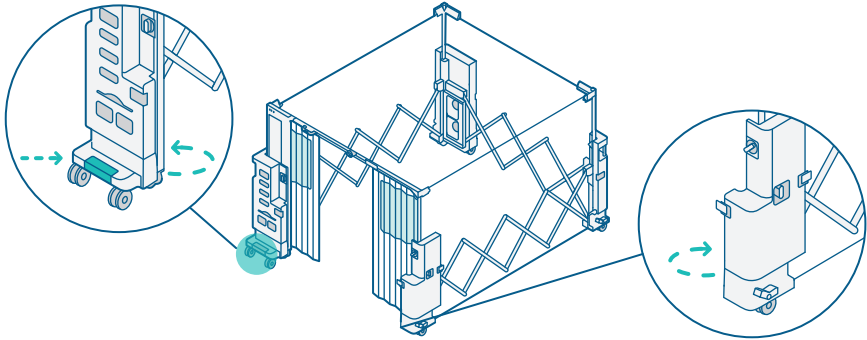

OPENING THE DOORS

To open the doors to enter Rediroom, simply press your foot on the foot pedal located outside of Rediroom. To close the door, press your foot on the foot pedal again.

The doors will close automatically after 5 seconds.

Once the doors are in the open position, pressing twice in succession on the foot pedal will keep the doors in the open position. If the pedal is pressed again, the doors will return to the closed position.

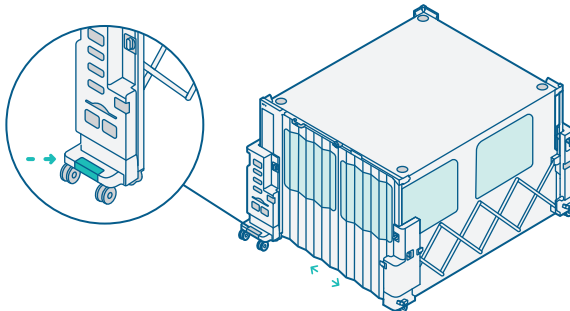

PATIENT PRIVACY

For privacy, the window covers can remain up.

To reveal the windows, which are found on the doors and walls, simply peel back the covers from the inside of the canopy.

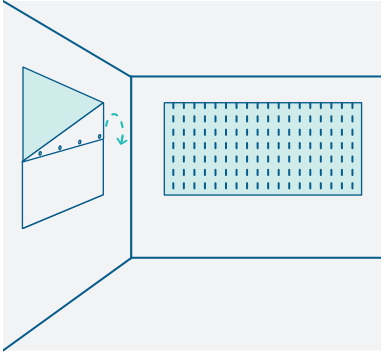

REACHING HOSPITAL SERVICES

To reach rear-wall services, reach through the unique double-layered perforated window.

If cables are connected to ESD sensitive equipment do not plug the cables into equipment until after they have been pushed through the double-layered perforated window.

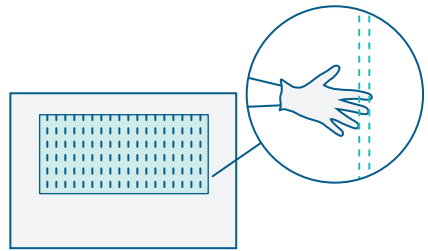

NOTICE BOARD LED LIGHTS

There are three LED lights on the front panel above the notice board:

- 2 x fan speed monitor notification lights
- Door ready notification light

Both LED lights should be illuminated green to indicate that the curtain door is ready to operate and that the fans are running at optimal speed. If the fans are not at speed then the corresponding LED light will indicate orange. If the notice board has not been lifted up high enough then the Door Ready LED will not be illuminated, indicating that there is no power supplied to the door.

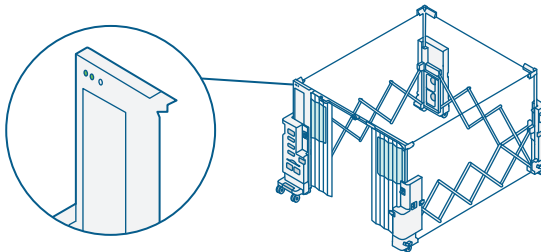

How to use.

Setup, Cleaning & Packdown

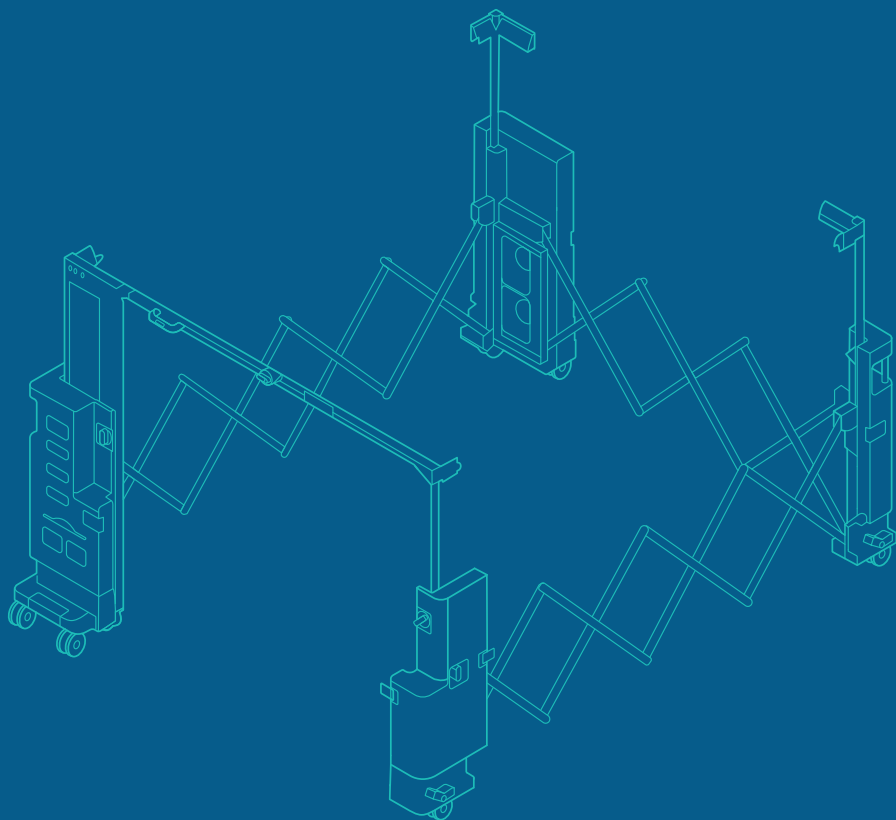

BEFORE CLEANING

DISPOSE OF CANOPY & HEPA FILTER

The canopy should be released at all four corners (**decal A**), the HEPA filter removed and both placed in the appropriate healthcare waste stream. Any disposable items should be removed from the cart before commencing cleaning.

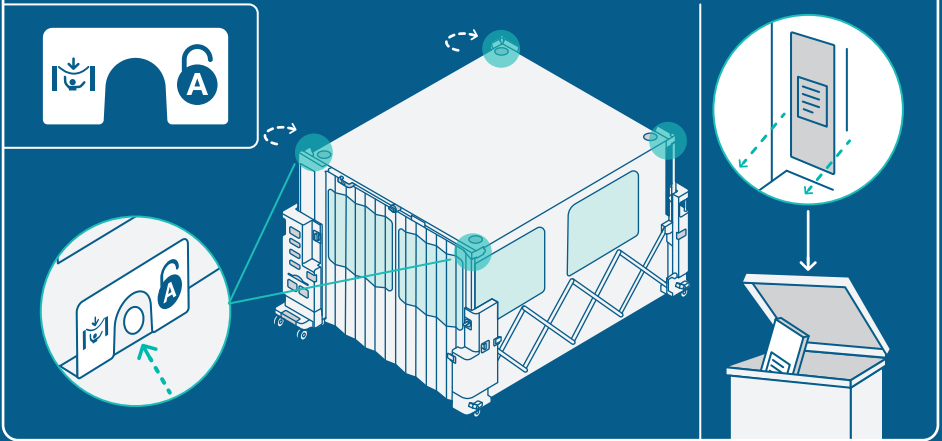

PERFORM HAND HYGIENE



WEAR APPROPRIATE PPE

Carry out a risk assessment to determine what PPE is needed.



Scan the QR code to watch our demonstration video.

5 PRINCIPLES OF CLEANING

Our decontamination instructions should be integrated in line with your local standard and transmission based precautions policies (e.g. hand hygiene, personal protective equipment, cleaning of care equipment and waste management).

We recommend that you risk assess whether you use Clinell Universal Wipes, Clinell Peracetic Acid Wipes or other approved cleaning agents for decontaminating Redroom, which can be found in the Product Manual. Then follow our **5 Principles of Cleaning**:

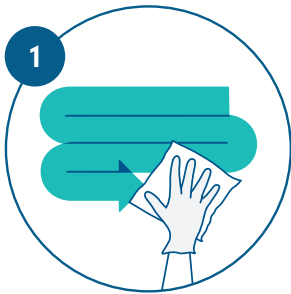

WIPE IN AN 'S' SHAPED PATTERN

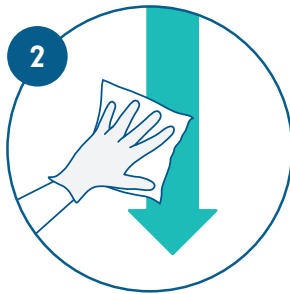

WORK FROM TOP TO BOTTOM

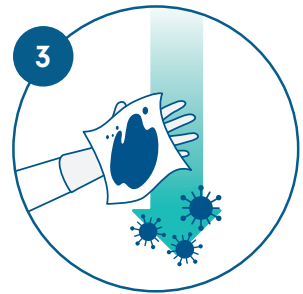

WIPE FROM CLEAN TO DIRTY

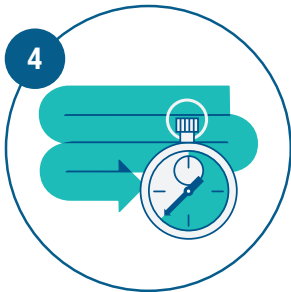

ENSURE CORRECT CONTACT TIME



ONE WIPE, ONE SURFACE

NOTE

Please change the wipe regularly especially if it becomes dry or soiled and remember to let all surfaces air dry.

NOTE

If using a Cart Cover, the cover is recommended to be cleaned, both inside and out, using the same 5 principles of cleaning before being applied to the cart.

HOW TO CLEAN REDIROOM - INSIDE

Every surface of the Rediroom frame must be cleaned. To make sure they are, we recommend first working your way around the **inside of the frame, moving anti-clockwise**. Use a new wipe for each section or when visibly soiled.

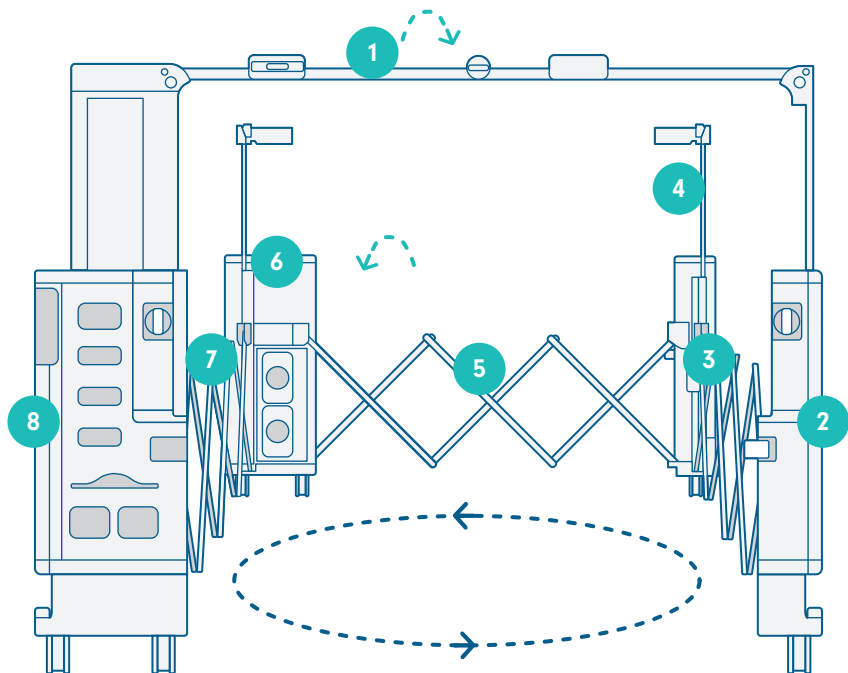

1

Inner curtain canopy rail.
From right to left including
the bottom of the rail.



2

Inner aspect of
the front right pillar
from top to bottom,
including the
brakes and wheels.



3

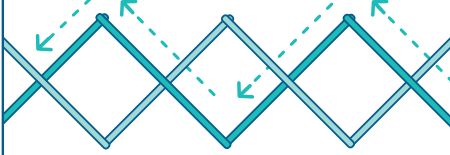

Inner scissor side rail between the front right pillar and the back right pillar. First the front rail then the back.

4

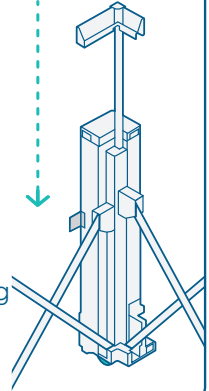

Inner back right pillar from top to bottom, including the brakes and wheels.

5

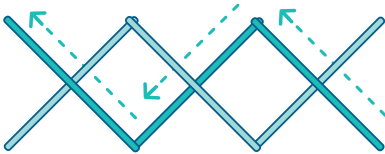

Inner scissor side rail between the back right pillar and the back left pillar (the one that houses the HEPA filter). First the front rail then the back.

6

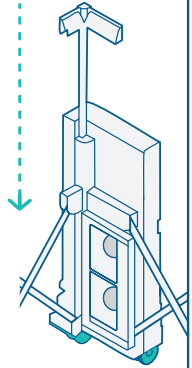

Inner back left pillar from top to bottom, including the brakes, wheels, cable and plug.

7



Inner scissor side rail between the back left pillar and the front left pillar (the one that houses the PPE). First the front rail then the back.

8

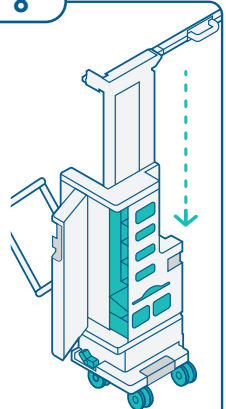

Inner front left pillar situated adjacent to the PPE compartments. Clean from top to bottom, including the brakes and four wheels.

HOW TO CLEAN REDIROOM - OUTSIDE

Every surface of the Rediroom frame must be cleaned. To make sure they are, we recommend working your way around the **outside of the frame, moving anti-clockwise**. Use a new wipe for each section or when visibly soiled.

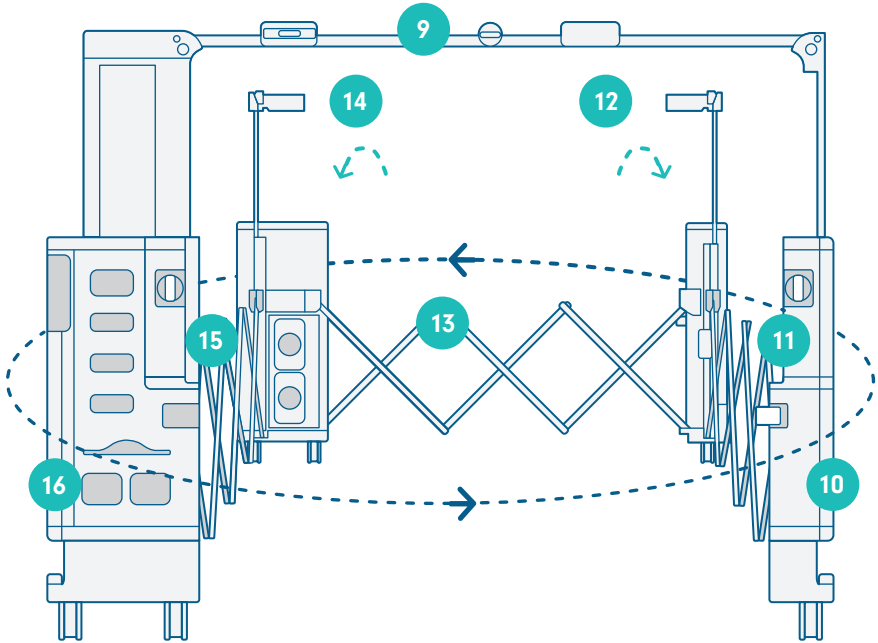

9

Outer canopy curtain rail from left to right, including the top of the rail, centre switch and the handle.

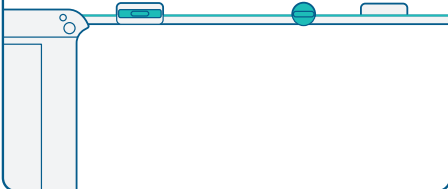

10

Outer aspect of the front right pillar from top to bottom, including the brakes and wheels.

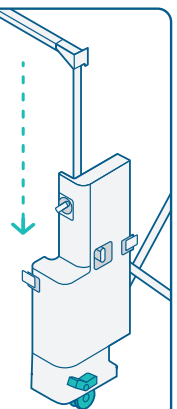

11

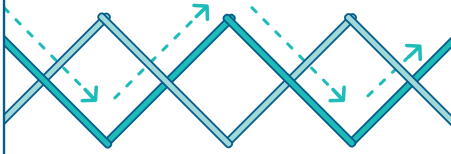

Outer scissor side rail between the front right pillar and the back right pillar. First the front rail then the back.

12

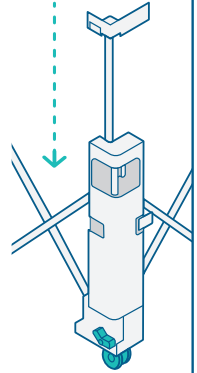

Outer back right pillar from top to bottom, including the brakes and wheels.

13

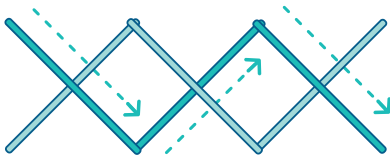

Outer scissor side rail between the back right pillar and the back left pillar (the one that houses the HEPA filter). First the front rail then the back.

14

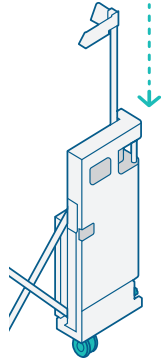

Outer back left pillar from top to bottom, including the brakes, wheels, cable and plug.

15

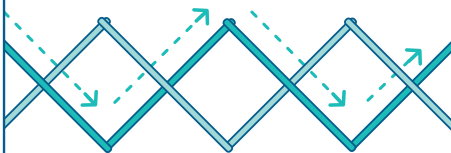

Outer scissor side rail between the back left pillar and the front left pillar (the one that houses the PPE). First the front rail then the back.

16

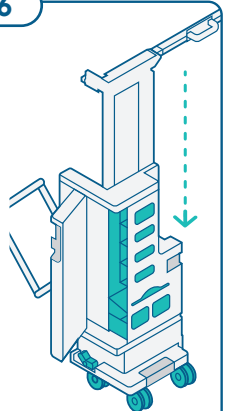

Outer front left pillar from top to bottom, including the brakes, wheels and each aspect of the inner compartment.

REDIROOM CLEANING PROTOCOL

Decontamination of Rediroom should take place:



BETWEEN EACH PATIENT USE

After occupation, Rediroom should be terminally cleaned.



AT REGULAR, PRE-DEFINED INTERVALS

All parts of Rediroom (including wheels, castors and underneath) should be decontaminated on a regular basis.



AFTER BLOOD/BODY FLUID CONTAMINATION

If Rediroom becomes contaminated with blood or body fluids, you should perform a risk assessment and decontaminate as per the principles outlined on page 9.



BEFORE INSPECTION, SERVICING OR REPAIR

To protect service personnel, Rediroom should undergo a documented clean to the same standard as between patient use.



BEFORE DISPOSAL

If Rediroom has to be decommissioned, it should be fully decontaminated as per the principles outlined on page 9 and disposed of as per local policy.

How to use.

Setup, Cleaning & Packdown

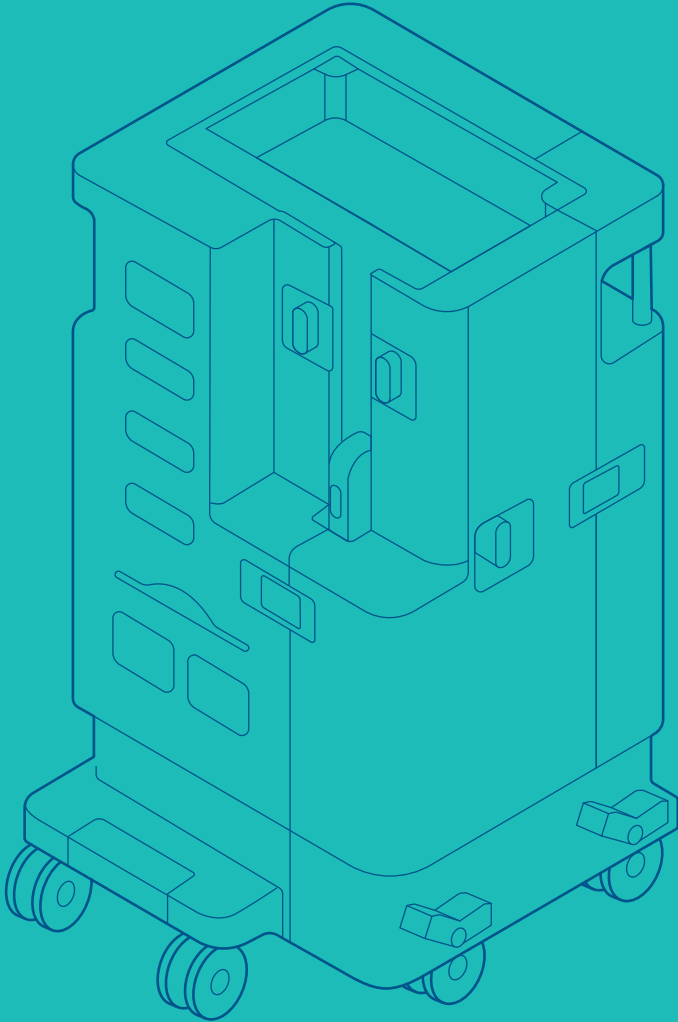

BEFORE PACKDOWN

COMPLETE CLEANING PROTOCOL



Scan the QR code to watch our demonstration video.

REDIROOM PACKDOWN

After cleaning, Rediroom can be packed down in 5 minutes. The **letter** decals on the machine will help guide you through the packdown steps.

COLLAPSING THE FRAME

Unlock the front wheels (**decals B & C**) and the scissor locks (**decals D & E**). Push the front of the machine backwards to connect the front and back pillars, then close with the side latches (**decals F & G**).

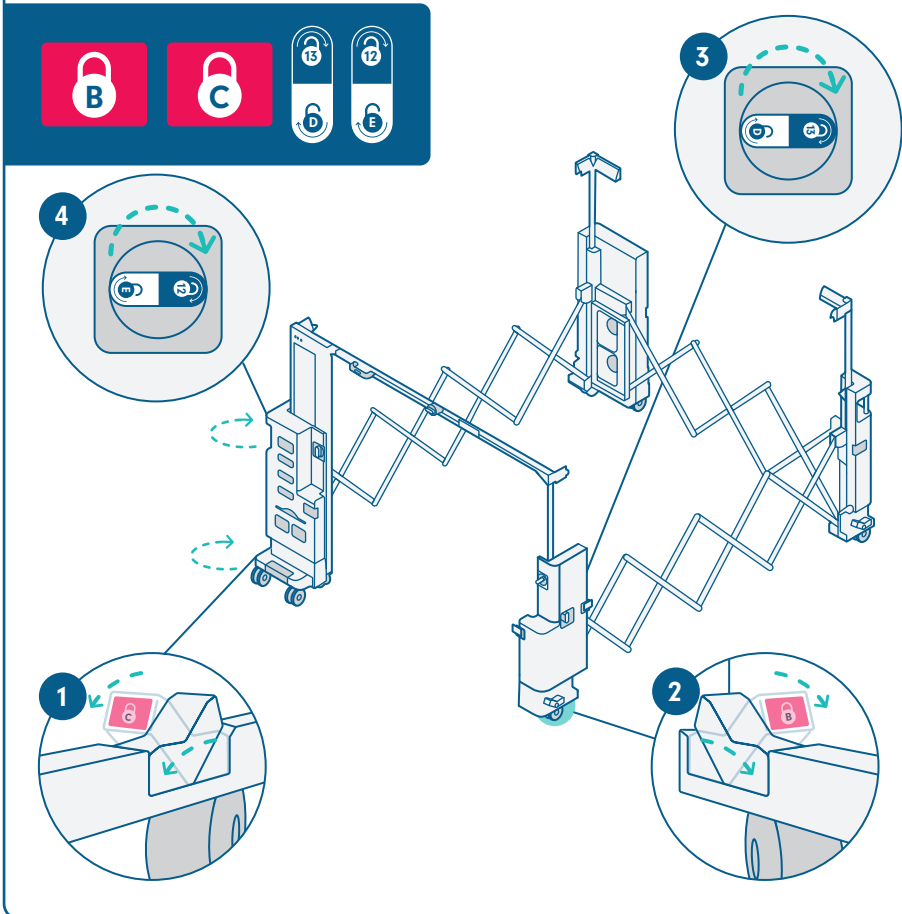

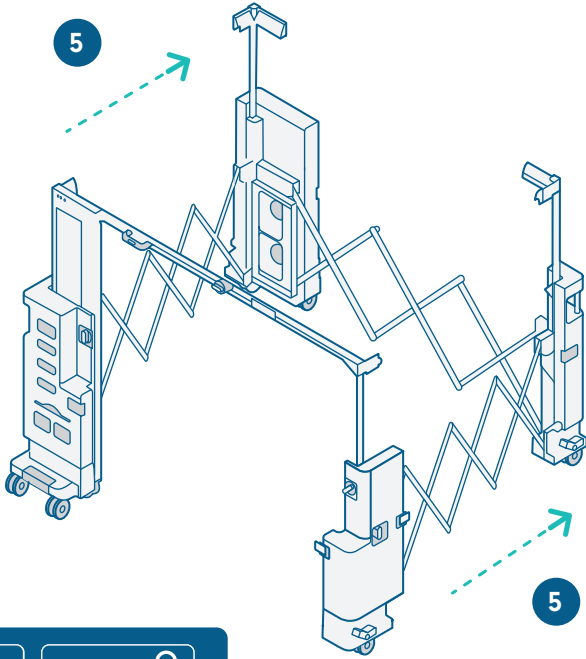

11 →	← 10
F ←	→ G

6

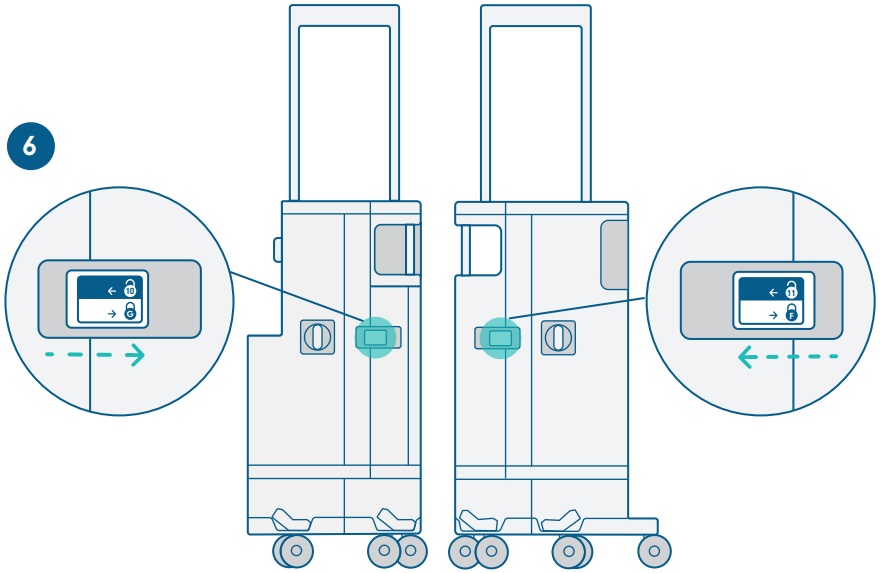

REFORMING THE CART

Unlock the rear-right wheel (**decal H**) and the curtain rail (**decal I**). At this point the curtain-rail should begin to collapse down. Push the right-hand side of the frame towards the left and close the front & back latches (**decals J & K**).

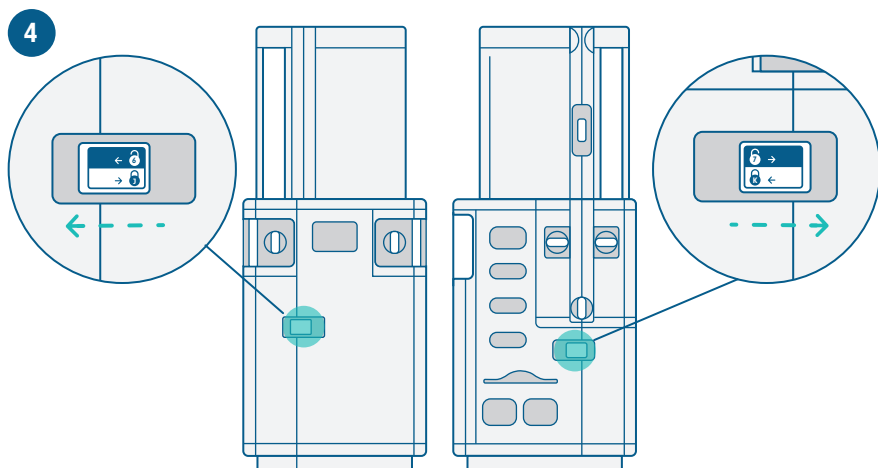
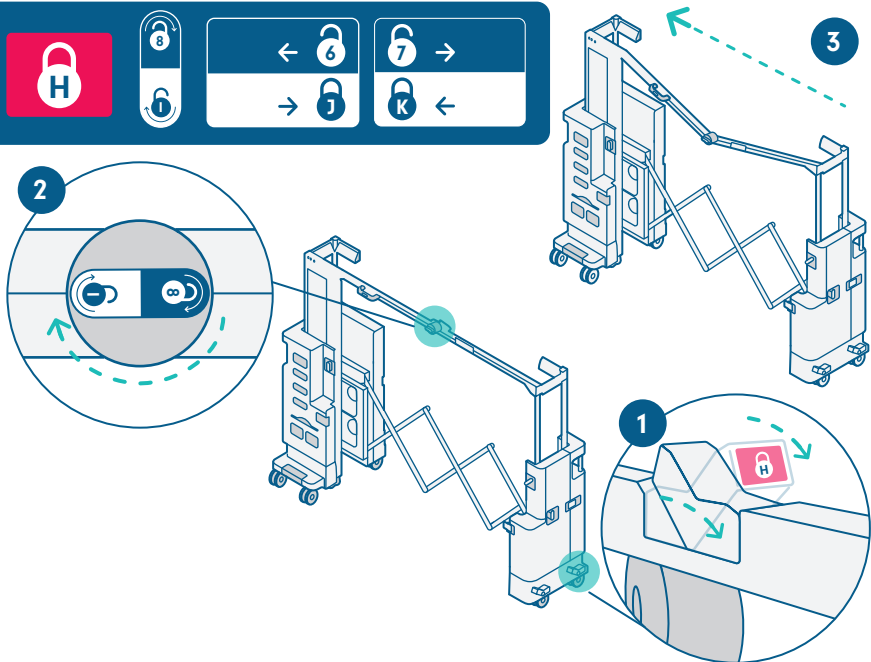

DROPPING THE PILLAR

Unlock the posts (decals L, M, N & O), hold the curtain rail handle (decals P) and lower the pillar until it locks. Bring down the rear corner posts and lock the rear-right wheel (decals Q).



1

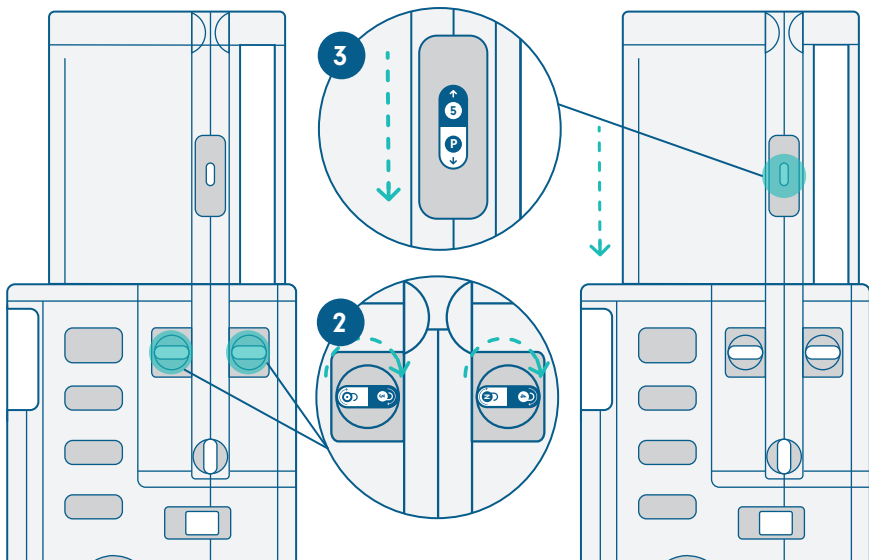
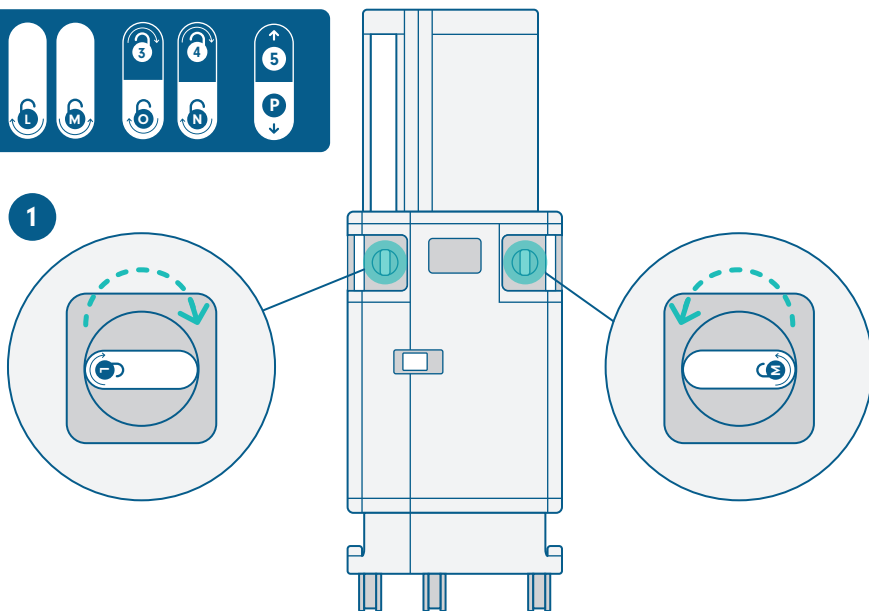

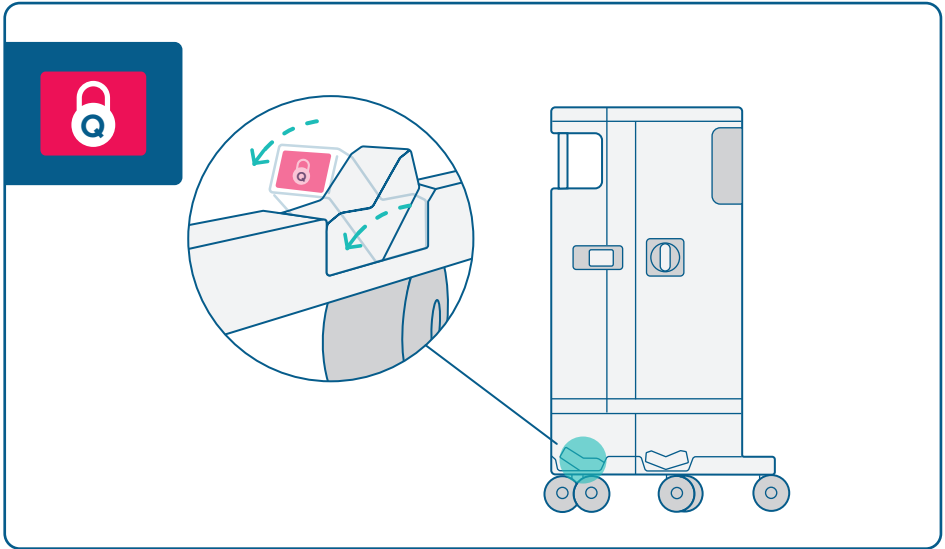

FINISHED

Rediroom is now fully packed down.

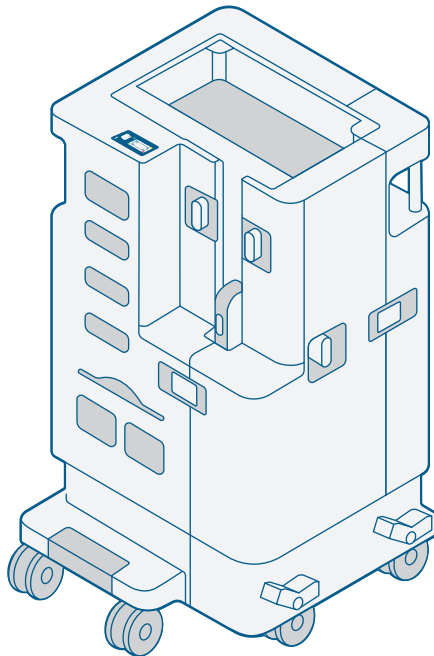

CONTACT AND SUPPORT

Technical support and general enquiries

T: +44 (0)20 7993 0030

E: support@gamahealthcare.com



About GAMA Healthcare

GAMA Healthcare is at the forefront of infection prevention technology. Founded in 2004 by two NHS doctors, we develop infection prevention products to help save and improve lives.

Today, our Clinell, Carell and Contiplan product ranges protect people in healthcare, businesses and homes across more than 60 countries. Our Clinell Universal Wipes are the NHS' number 1 most used disinfectant wipe, trusted by 9 out of 10 NHS hospitals to help safeguard patients and healthcare workers from the risk of infection.

Rediroom is the world's first instant patient isolation room. In development since 2012, this patented system isolates a single patient in less than 5 minutes.



GAMA Healthcare Ltd.,
The Maylands Building,
Maylands Avenue, Hemel Hempstead,
Hertfordshire, HP2 7TG, UK.

Tel: +44 (0)20 7993 0030
E-mail: info@gamahealthcare.com

JBN200657



EMERGO EUROPE
Prinsessegracht 20
2514 AP The Hague
The Netherlands